

# Bucse de strângere

STAS 5814

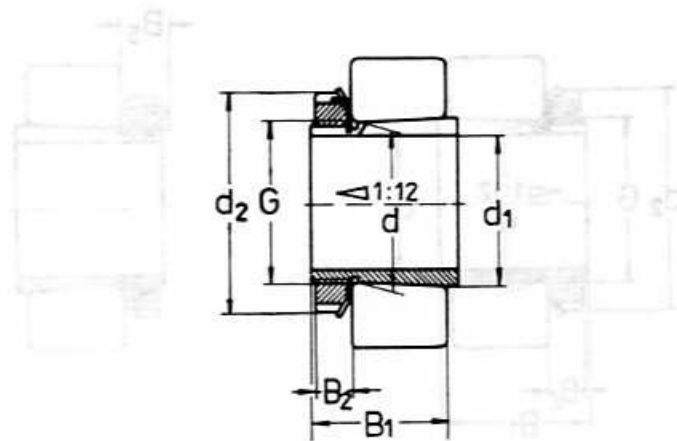

Dimensiuni		d <sub>2</sub>	B <sub>1</sub>	B <sub>2</sub>	B <sub>5</sub>	G	Simbol bucșă STAS 5814	piuliță STAS 5816	șaiță STAS 5815	Masa
d <sub>1</sub>	d									kg
17	20	32	24	7		M20×1	H204	KM4	MB4	0,041
	20	32	28	7		M20×1	H304	KM4	MB4	0,045
	20	32	31	7		M20×1	H2304	KM4	MB4	0,049
20	25	38	26	8		M25×1,5	H205	KM5	MB5	0,070
	25	38	29	8		M25×1,5	H305	KM5	MB5	0,075
	25	38	35	8		M25×1,5	H2305	KM5	MB5	0,087
25	30	45	27	8		M30×1,5	H206	KM6	MB6	0,099
	30	45	31	8		M30×1,5	H306	KM6	MB6	0,109
	30	45	38	8		M30×1,5	H2306	KM6	MB6	0,126
30	35	52	29	9		M35×1,5	H207	KM7	MB7	0,125
	35	52	35	9		M35×1,5	H307	KM7	MB7	0,142
	35	52	43	9		M35×1,5	H2307	KM7	MB7	0,165
35	40	58	31	10		M40×1,5	H208	KM8	MB8	0,174
	40	58	36	10		M40×1,5	H308	KM8	MB8	0,189
	40	58	46	10		M40×1,5	H2308	KM8	MB8	0,224
40	45	65	33	11		M45×1,5	H209	KM9	MB9	0,227
	45	65	39	11		M45×1,5	H309	KM9	MB9	0,248
	45	65	50	11		M45×1,5	H2309	KM9	MB9	0,280
45	50	70	35	12		M50×1,5	H210	KM10	MB10	0,274
	50	70	42	12		M50×1,5	H310	KM10	MB10	0,303
	50	70	55	12		M50×1,5	H2310	KM10	MB10	0,362
50	55	75	37	12		M55×2	H211	KM11	MB11	0,308
	55	75	45	12		M55×2	H311	KM11	MB11	0,345
	55	75	59	12		M55×2	H2311	KM11	MB11	0,420
55	60	80	38	13		M60×2	H212	KM12	MB12	0,346
	60	80	47	13		M60×2	H312	KM12	MB12	0,394
	60	80	62	13		M60×2	H2312	KM12	MB12	0,481
60	65	85	40	14		M65×2	H213	KM13	MB13	0,401
	65	85	50	14		M65×2	H313	KM13	MB13	0,458
	65	85	65	14		M65×2	H2313	KM13	MB13	0,557
	70	92	41	14		M70×2	H214	KM14	MB14	0,593
	70	92	52	14		M70×2	H314	KM14	MB14	0,723
70	92	68	14		M70×2	H2314	KM14	MB14	0,897	
65	75	98	43	15		M75×2	H215	KM15	MB15	0,707
	75	98	55	15		M75×2	H315	KM15	MB15	0,831
	75	98	73	15		M75×2	H2315	KM15	MB15	1,05
70	80	105	46	17		M80×2	H216	KM16	MB16	0,882
	80	105	59	17		M80×2	H316	KM16	MB16	1,03
	80	105	78	17		M80×2	H2316	KM16	MB16	1,28

# Bucșe de strângere

STAS 5814

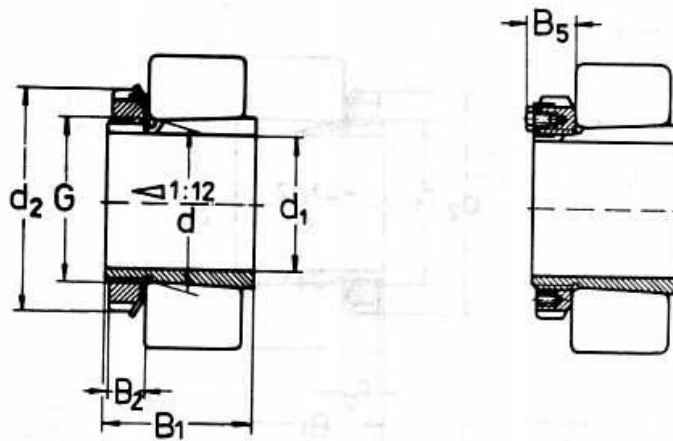

Dimensiuni		d <sub>2</sub>	B <sub>1</sub>	B <sub>2</sub>	B <sub>5</sub>	G	Simbol bucșă STAS 5814	piuliță STAS 5816	șabă STAS 5815	Masa
d <sub>1</sub>	d									
mm										
75	85	110	50	18		M85×2	H217	KM17	MB17	1,02
	85	110	63	18		M85×2	H317	KM17	MB17	1,18
	85	110	82	18		M85×2	H2317	KM17	MB17	1,45
80	90	120	52	18		M90×2	H218	KM18	MB18	1,19
	90	120	65	18		M90×2	H318	KM18	MB18	1,37
	90	120	86	18		M90×2	H2318	KM18	MB18	1,69
85	95	125	55	19		M95×2	H219	KM19	MB19	1,37
	95	125	68	19		M95×2	H319	KM19	MB19	1,56
	95	125	90	19		M95×2	H2319	KM19	MB19	1,92
90	100	130	58	20		M100×2	H220	KM20	MB20	1,49
	100	130	71	20		M100×2	H320	KM20	MB20	1,69
	100	130	76	20		M100×2	H3120	KM20	MB20	1,80
	100	130	97	20		M100×2	H2320	KM20	MB20	2,15
100	110	145	63	21		M110×2	H222	KM22	MB22	1,93
	110	145	77	21		M110×2	H322	KM22	MB22	2,18
	110	145	81	21		M110×2	H3122	KM22	MB22	2,25
	110	145	105	21		M110×2	H2322	KM22	MB22	2,74
110	120	145	72	22		M120×2	H3024	KML24	MBL24	1,93
	120	155	88	22		M120×2	H3124	KM24	MB24	2,64
	120	155	112	22		M120×2	H2324	KM24	MB24	3,19
115	130	155	80	23		M130×2	H3026	KML26	MBL26	2,85
	130	165	92	23		M130×2	H3126	KM26	MB26	3,66
	130	165	121	23		M130×2	H2326	KM26	MB26	4,60
125	140	165	82	24		M140×2	H3028	KML28	MBL28	3,16
	140	180	97	24		M140×2	H3128	KM28	MB28	4,34
	140	180	131	24		M140×2	H2328	KM28	MB28	5,55
135	150	180	87	26		M150×2	H3030	KML30	MBL30	3,89
	150	195	111	26		M150×2	H3130	KM30	MB30	5,52
	150	195	139	26		M150×2	H2330	KM30	MB30	6,63
140	160	190	93	27,5		M160×3	H3032	KML32	MBL32	5,21
	160	210	119	28		M160×3	H3132	KM32	MB32	7,67
	160	210	147	28		M160×3	H2332	KM32	MB32	9,14
150	170	200	101	28,5		M170×3	H3034	KML34	MBL34	5,99
	170	220	122	29		M170×3	H3134	KM34	MB34	8,38
	170	220	154	29		M170×3	H2334	KM34	MB34	10,2
160	180	210	109	29,5		M180×3	H3036	KML36	MBL36	6,83
	180	230	131	30		M180×3	H3136	KM36	MB36	9,50
	180	230	161	30		M180×3	H2336	KM36	MB36	11,3
170	190	220	112	30,5		M190×3	H3038	KML38	MBL38	7,45
	190	240	141	31		M190×3	H3138	KM38	MB38	10,8

# Bucșe de strângere

STAS 5814



Dimensiuni d <sub>1</sub>	d	d <sub>2</sub>	B <sub>1</sub>	B <sub>2</sub>	B <sub>5</sub>	G	Simbol bucșă STAS 5814	piuliță STAS 5816	șaiță/ scoabă STAS 5815	Masa
mm										kg
170	190	240	169	31		M190×3	H2338	KM38	MB38	12,6
180	200	240	120	31,5		M200×3	H3040	KML40	MBL40	9,19
	200	250	150	32		M200×3	H3140	KM40	MB40	12,1
	200	250	176	32		M200×3	H2340	KM40	MB40	13,9
200	220	260	128	30	41	Tr220×4	H3044	HM3044	MS3044	10,3
	220	280	161	36		Tr220×4	H3144	HM3144	MB44	14,7
	220	280	186	36	44	Tr220×4	H2344	HM2344	MB44	16,7
220	240	290	133	34	46	Tr240×4	H3048	HM3048	MS3048	13,2
	240	300	172	38		Tr240×4	H3148	HM3148	MB48	17,3
	240	300	199	38	46	Tr240×4	H2348H	HM3148H	MB48	19,7
240	260	310	145	34	46	Tr260×4	H3052	HM3052	MS3052	15,3
	260	330	190	39		Tr260×4	H3152	HM3152	MB52	22,0
	260	330	211	39		Tr260×4	H2352H	HM3152H	MB52	24,2
260	280	330	152	38	50	Tr280×4	H3056	HM3056	MS3056	17,7
	280	350	195	41		Tr280×4	H3156	HM3156	MB56	24,5
	280	350	224	41		Tr280×4	H2356H	HM3156	MB56	27,8
280	300	360	168	42	54	Tr300×4	H3060	HM3060	MS3060	22,8
	300	380	208	40	53	Tr300×4	H3160H	HM3160H	MS3160	30,2
	300	380	240	40	53	Tr300×4	H3260H	HM3160	MS3160	34,1
300	320	380	171	42	55	Tr320×5	H3064H	HM3064H	MS3064	24,6
	320	400	226	42	56	Tr320×5	H3164H	HM3164	MS3164	34,9
	320	400	258	42	56	Tr320×5	H3264H	HM3264H	MS3264	39,3
320	340	400	187	45	58	Tr340×5	H3068H	HM3068H	MS3068	28,7
	340	440	254	55	72	Tr340×5	H3168H	HM3168H	MS3168	49,5
	340	440	288	55	72	Tr340×5	H3268H	HM3168	MS3168	51,5
340	360	420	188	45	58	Tr360×5	H3072H	HM3072H	MS3072	30,5
	360	460	259	58	75	Tr360×5	H3172H	HM3172H	MS3168	54,2
	360	460	299	58	75	Tr360×5	H3272H	HM3172	MS3172	60,5
360	380	450	193	48	62	Tr380×5	H3076H	HM3076H	MS3076	35,8
	380	490	264	60	77	Tr380×5	H3176H	HM3176H	MS3176	61,7
	380	490	310	60	77	Tr380×5	H3276H	HM3176	MS3176	69,5
380	400	470	210	52	66	Tr400×5	H3080H	HM3080H	MS3076	41,3
	400	520	272	62	82	Tr400×5	H3180H	HM3180H	MS3180	70,6
	400	520	328	62	81	Tr400×5	H3280H	HM3180	MS3180	96,0
400	420	490	212	52	66	Tr420×5	H3084H	HM3084H	MS3084	43,7
	420	540	304	70	90	Tr420×5	H3184H	HM3184H	MS3180	84,2
	420	540	352	70	89	Tr420×5	H3284H	HM3184	MS3184	112
410	440	520	228	60	77	Tr440×5	H3088H	HM3088H	MS3088	65,2
	440	560	307	70	90	Tr440×5	H3188H	HM3188H	MS3188	104

# Bucse de strângere

STAS 5814

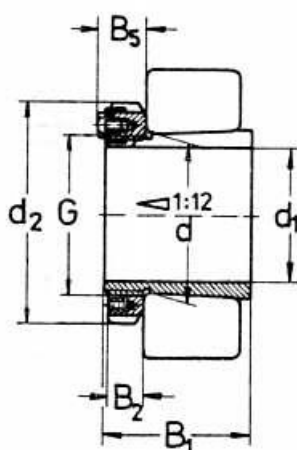

Dimensiuni		d <sub>2</sub>	B <sub>1</sub>	B <sub>2</sub>	B <sub>5</sub>	G	Simbol bucșă STAS 5814	piuliță STAS 5816	scoabă STAS 5815	Masa
d <sub>1</sub>	d									
mm										
410	440	560	361	70	88	Tr440×5	H3288H	HM3188	MS3188	135
430	460	540	234	60	77	Tr460×5	H3092H	HM3092H	MS3088	69,5
	460	580	326	75	95	Tr460×5	H3192H	HM3192H	MS3188	116
	460	580	382	75	94	Tr460×5	H3292H	HM3192	MS3192	154
450	480	560	237	60	77	Tr480×5	H3096H	HM3096H	MS3096	73,3
	480	620	335	75	95	Tr480×5	H3196H	HM3196H	MS3196	133
	480	620	397	75	94	Tr480×5	H3296H	HM3196	MS3196	187
470	500	580	208	68	83	Tr500×5	H39/500H	HM30/530	MS30/500	76,0
	500	580	247	68	85	Tr500×5	H30/500H	HM30/500H	MS3096	81,8
	500	630	356	80	100	Tr500×5	H31/500H	HM31/500H	MS31/500	143
	500	630	428	80	99	Tr500×5	H32/500H	HM31/500	MS31/500	191
500	530	630	216	68	89	Tr530×5	H39/530H	HM30/530	MS30/530	91,0
	530	630	265	68	90	Tr530×5	H30/530H	HM30/530	MS30/530	105
530	560	650	227	75	96	Tr560×6	H39/560H	HM30/560	MS30/560	101
	560	650	282	75	96	Tr560×6	H30/560H	HM30/560	MS30/560	117
560	600	700	239	75	96	Tr600×6	H39/600H	HM30/600	MS30/600	128
	600	700	289	75	96	Tr600×6	H30/600H	HM30/600	MS30/600	147
600	630	730	254	75	96	Tr630×6	H39/630H	HM30/630	MS30/630	121
	630	730	301	75	96	Tr360×6	H30/630H	HM30/630	MS30/630	139
630	670	780	264	80	101	Tr670×6	H39/670H	HM30/670	MS30/670	174
	670	780	324	80	101	Tr670×6	H30/670H	HM30/670	MS30/670	193
670	710	830	286	90	111	Tr710×7	H39/710H	HM30/710	MS30/710	217
	710	830	342	90	111	Tr710×7	H30/710H	HM30/710	MS30/710	221
710	750	870	291	90	111	Tr750×6	H39/750H	HM30/750	MS30/750	226
750	800	920	303	90	111	Tr800×7	H39/800H	HM30/800	MS30/800	294
	800	920	366	90	111	Tr800×7	H30/800H	HM30/800	MS30/800	311
800	850	980	308	90	115	Tr850×7	H39/850H	HM30/850	MS30/850	307
850	900	1 030	326	100	125	Tr900×7	H39/900H	HM30/900	MS30/900	374
	900	1 030	400	100	125	Tr900×7	H30/900H	HM30/900	MS30/900	387
900	950	1 080	344	100	125	Tr950×8	H39/950H	HM30/950	MS30/950	362